



UNCTAD / February 2022



1 ASYCUDA Ecosystem



Contributes to improved coordination between stakeholders in trade



**Extended
Customs & Trade
Automation**



**Paperless
Processing
Initiatives**



**Enhanced
Interoperability
& Integration**



**Technical &
Functional
Support**



ASYCUDA Key Facts

100+
Countries & territories

39 LDCs
34 SIDS
21 LLDCs

 23
New projects
/addenda
signed in 2021

UNCTAD largest TC 

2019 **21** million US\$ 48% of total expenditures

2020 **17** million US\$ 60% of total expenditures 

Current operations in
60+ countries

Human
Resources



133



USING
ASYCUDAWorld

Project funding

72%
Beneficiary
Governments



ASYCUDA
40
YEARS

Programme initiated in 1980's
to support customs automation
and trade facilitation reforms

Digital Transformation

Partnerships with Other UN agencies for simplification and streamlining of the trade procedures



AGENCIES	SCOPE
Convention on International Trade in Endangered Species of Wild Fauna and Flora CITES ¹	Development and piloting of ASYCUDA module for monitoring trade in endangered species (eCITES)
International Organization for Migration IOM	Development of interface between ASYCUDA and MIDAS where both systems were implemented
Office for Coordination of Humanitarian Affairs OCHA	Development and piloting of ASYCUDA module for humanitarian relief consignments (ASYREC Relief Consignments)
UN Environment Programme UNEP	Cooperation implementing Ozone Depleting Substance management and control module
Universal Postal Union UPU	Development of interface between ASYCUDA and UPU's electronic system for real time data exchange (ASYPCD Messaging)
World Customs Organization WCO	Development and piloting of ASYCUDA module for performance measurement (ASYPM)
World Intellectual Property Organization WIPO	Development and piloting of ASYCUDA tools for IPR protection
World Trade Organization WTO and International Trade Centre ITC	Development of ASYCUDA tool for capturing & sending national data to the WTO Integrated Trade Database (Trade Data Extraction)

¹ The CITES Secretariat is administered by UNEP.

Building ASYCUDA Data Ecosystem

Digitalisation projects



Digital Customs

- ▶ **ASYCUDAWorld** version(s), including alignments with regional Customs Unions requirements (EU, EACU, EAC, CARICOM, COMESA, etc.)

Digital Partner Government Agency

- ▶ **Permits management solutions** integrated with customs systems

Interconnectivity (national/international)

- ▶ **Cross-Border Information Exchange** (Customs, Transport, Regulatory data integration and processing)

Single Window environments

- ▶ **Customs-centric Single Window**

Digital solutions (movement of goods & persons)



Extraction module that aggregates and transfers tariff and trade data from ASYCUDA to the World Trade Organization's (WTO) Integrated Database (IDB).



Interface of UNCTAD/ASYCUDA with UPU/CDS for effective and efficient management of cross-border E-Commerce.



Statistical reporting module providing a set of standard reports, and the tools to develop other ad hoc reports.



Extraction tool that compiles and transfers trade-related customs data from ASYCUDA the African Trade Observatory (ATO).



Business intelligence - Performance Measurement for strategic decision.



Collection of integrated applications and solutions developed by UNCTAD/ASYCUDA at the request of member states to address the needs of different regulatory agencies, and to achieve the required balance between trade control and facilitation.



This function will further assist customs intelligence in achieving efficient and fully automated risk management at different stages of the clearance process.



Module that supports the Customs Department in facilitating legitimate travelers and managing risks.



Development of a cloud-based electronic permit system offering automated support for permit application, processing, issuance, and reporting.



Platform to facilitate the electronic exchange and processing of electronic Sea Cargo Manifest pre-arrival (Entry) and pre-departure (Exit) data.



Module to facilitate legitimate Humanitarian aid through efficient, managed and automated coordination workflow before, during and post disaster.



ASYCUDA module for the management of the mineral value chain, from mineral extraction all the way to export of the final product. This module is aimed at mineral traders, ministry of mines and customs.



It aims at enhancing the ability of customs administrations to successfully detect and prosecute fraudulent practices and mount an effective response to the malpractices of undervaluation and under-invoicing.



ASYCUDA module for the management of sanitary and phytosanitary certificates.



Collection and processing of trade in services data for National Statistical Offices (NSOs) in member states of the UEMOA. It is a cooperation between ASYCUDA and UNCTAD's Development Statistics and Information Branch (DSIB).



1 ASYCUDA Ecosystem



Enabling shipping agents, Customs and other border agencies to gain digital access to Advance Cargo Information in order to further enhance risk-based pre-arrival/pre-departure processing as stipulated in Art. 7.1 and 7.4 of the Trade Facilitation Agreement (TFA)



Main Objectives

- ▶ Implementation of ASYHUB Data Exchange and Data Integration platform between ASYCUDA System and ship data provider's ICT systems to facilitate the **processing of electronic Sea Cargo Manifest pre-arrival (Entry) and pre-departure (Exit)**



- ▶ Facilitate submission and processing of declarations, notifications, supporting documents **prior to the presentation of goods**



Project Partners



Federal Ministry
for Economic Cooperation
and Development



DGMT

- ▶ Process advance sea cargo data pre-arrival/pre-departure
- ▶ Conduct its risk analyses earlier to determine which cargoes to target
- ▶ Reduce the time and cost of maritime trade

giz



**TRADE
LENS**



Customs formalities in relation with Entry/Exit and Clearance (Maritime)

- ▶ **Entry of goods**
 - Customs Cargo Manifest (at arrival);
 - Entry Summary Declaration;
 - Arrival notification;
 - Presentation notification;
 - Temporary Storage Declaration
- ▶ **Exit of goods**
 - Customs Cargo Manifest (at departure);
 - Exit notification
- ▶ **Import/Export formalities**
 - Pre-Arrival/Departure Processing



Objectives

- Enable **automatic data exchange** between Ship-data-providers and Customs administrations
- **Streamline submission** and **information sharing**. Automate the **risk analysis** process
- Further automate the processes of **Arrival, Presentation and Temporary storage (Entry), Exit**
- Introduce **Pre-arrival Processing (PaP)** and **Pre-departure Processing (PdP)**



Advance Cargo Information

- ▶ Enabling access to Advanced Cargo Information → facility to re-use data as to complete formalities in relation with entry into Customs territory



System-to-System interface

- ▶ Complementary way of submission of Advance Cargo Information → to further simplify and automate the process of submission of Sea Cargo Manifest information



Container Status Messages

- ▶ Additional supply chain visibility provided by container status messages → capability to track and trace movement of containers – End-to-End visibility



Pre-Arrival Processing

- ▶ Submission and processing of declarations, notifications, supporting documents, prior to the presentation of goods

Capabilities

- **Assisting traders to comply with relevant legal requirements**
- **Enabling further enhancements** as to cover other formalities such as: Ship's Stores Declaration, Crew's Effects Declaration, Crew List, Passenger List etc.

END-2-END Supply Chain Visibility

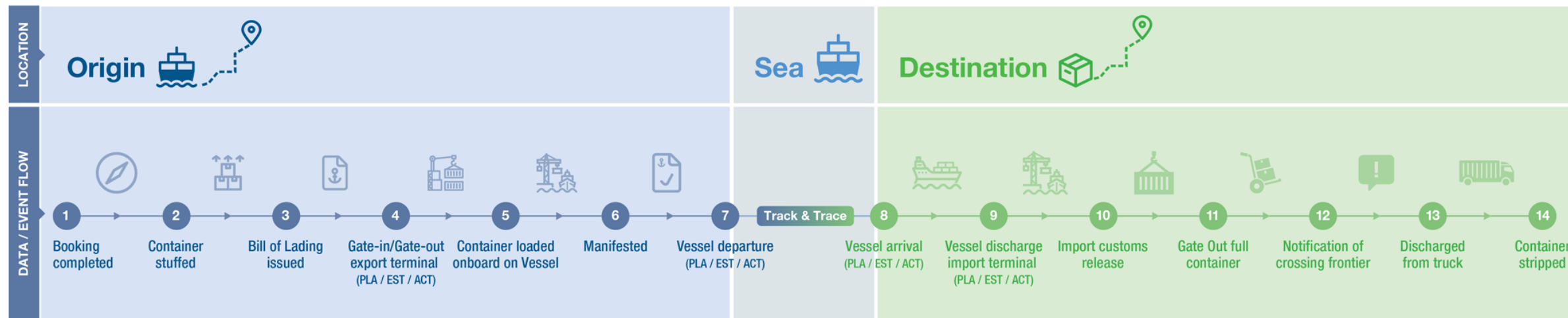

ASY HUB

Goods Items

Containers Information

Supply Chain Actors

Locations

Transport Document

Expected Benefits

- ▶ Harmonise and streamline the information exchange between Ship Data Providers and Customs authorities:
Increase trade facilitation and ensure a quicker release of goods
- ▶ Simplify and automate the process of submission of Sea Cargo Manifest information through a system-to-system interface:
Reduction of the administrative burden for ship data providers
- ▶ Re-use of data and automatic reconciliation for seamless flow of information: **Pre-arrival ➤ Arrival&Presentation ➤ Temporary Storage ➤ Clearance**



Expected Benefits

- ▶ Improved coordination of border agencies in respect of controls and information exchange:
Data pipeline to streamline border processes
- ▶ Access to additional information beyond declaration data:
Enrichment of manifest & declaration data with external data
- ▶ Enhanced cross-validation across datasets:
More accurate and reliable information & Bigger data pool for risk analysis



Use of Mobile devices to handle control results

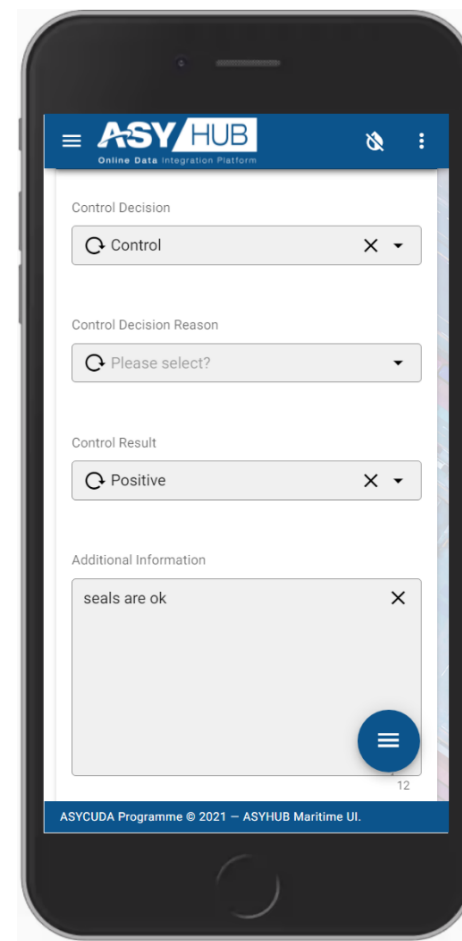
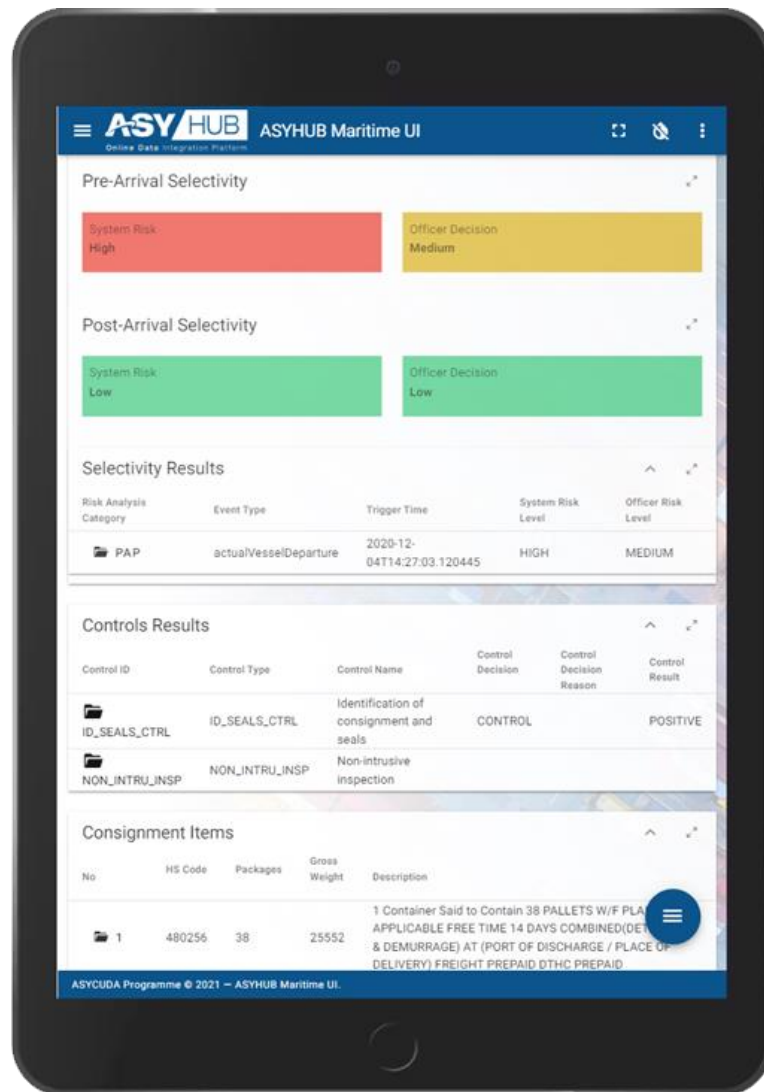

THANK YOU!

QUESTIONS & ANSWERS



📍 Palais des Nations, CH-1211 Geneva 10, Switzerland

🐦 @ascudaprogram

✉️ ascuda@unctad.org

💻 ascuda.org